

Affordable Housing for Seniors and People with Disabilities

Adams Park Apartments offers income-eligible seniors and people with disabilities attractive, well-maintained apartments designed especially to meet their needs. Residents enjoy friendly neighbors along with the following features and amenities:

- Affordable rent includes utilities
- Entrance intercom
- Security cameras in public areas
- Laundry facilities
- Major appliances furnished
- Full-time on-site housing and maintenance staff
- 24-hour emergency maintenance
- Full-time Resident Services Coordinator helps residents access community resources
- Small pets welcome
- Exercise Room
- On-site Food Pantry
- On-site Computer Lab
- Community Room with kitchen
- Recreational opportunities, social and educational events
- City bus stop adjacent



1440 Fuller Avenue SE, Grand Rapids, MI 49507 | (616) 235-2865

Conveniently located near shopping and transportation, Adams Park is a 188-unit development that serves people with disabilities and seniors ages 62 and older. Eligible tenants receive a federal rental subsidy, which means rent is not more than 30 percent of the household's adjusted monthly income.

Adams Park is operated by the Grand Rapids Housing Commission (GRHC). A Housing Application form for this and other GRHC developments is available online at www.grhousing.org. Prospective tenants can also get an application form and more information by calling the GRHC main office at 616/235-2600.

Adams Park Apartments is currently accepting applications from people with disabilities and seniors age 62 and older.

Tenants must meet the following income requirements:

Family Size	Maximum Annual Income
One	\$56,400
Two	\$64,450

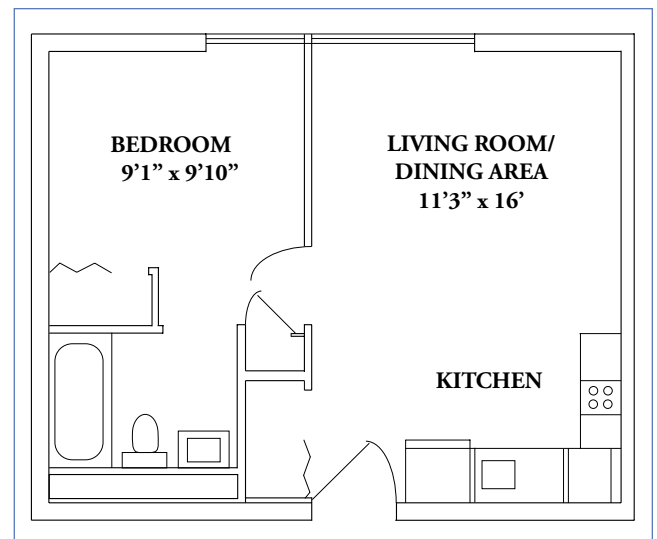

Floor plan of a typical apartment